

Schlüter®-BARA-RK

Edging profile
for exposed screed edges

5.4

Product data sheet

Application and Function

Schlüter®-BARA-RK is an edging profile for the exposed edges of surface coverings on balconies and terraces. The profile provides a neat edge appearance while protecting the exposed edges of the screed bed against weathering and corrosion.

The sloped projecting drip edge covers the exposed edges of the Schlüter®-TROBA-PLUS sub-surface drainage system which is installed below the load-distribution layer. During the application of the screed, the trapezoid-perforated anchoring leg of Schlüter®-BARA-RK is solidly embedded into the mortar bed while the upper edge of the profile is used to screed the mortar bed to the appropriate height. Schlüter®-TROBA-PLUS, serving as sub-surface drainage, shall be laid between the waterproofing layer and the screed in order to prevent penetrating water from collecting in the screed layer.

If Schlüter®-DITRA 25 is to be installed, the screed is levelled 3 mm below the top of the profile. Schlüter®-DITRA 25 uncouples the tile covering from the screed and neutralises stresses caused by differential movement, primarily due to temperature fluctuations, between the screed and the tile. In addition, Schlüter®-DITRA 25 in conjunction with the tile covering creates a bonded surface-waterproof layer.

Material

Schlüter®-BARA-RK is made of chromated and colour-coated aluminium.



Material properties and areas of application

The powder coating of the aluminium profile is colourfast, as well as UV and weather-resistant. The surface must be protected against abrasion.

Penetrating water must not collect in the screed bed into which Schlüter®-BARA-RK has been anchored (installation of drainage layer), since water enriched with alkali will attack aluminium. In special cases, the suitability of Schlüter®-BARA-RK must be verified based on the anticipated chemical, mechanical, and/or other stresses.

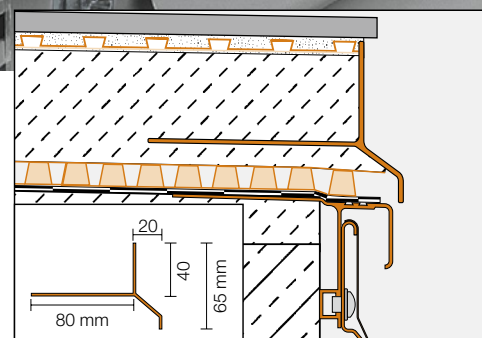



Installation

1. At the edge area, Schlüter®-BARA-RK is positioned into a layer of mortar. Prefabricated corner pieces for inside and outside corners are available. Between the ends of two profiles, a space of approximately 5 mm is left and covered by clipping on a connector.
2. Balcony and terrace surfaces shall be filled with mortar to the height at which the mortar bed's structural reinforcement (AKS lattice) is placed. In doing so, the reinforcing lattice must overlap the anchoring leg of the profile.
3. To produce the load distribution layer, the screed mortar is applied at the appropriate height and slope using the upper edge of Schlüter®-BARA-RK as a screeding guide. If Schlüter®-DITRA 25 is to be installed as an uncoupling and bonded waterproof membrane, the screed is levelled 3 mm below the top of the profile and carefully compacted.
4. Please Note:
Schlüter®-TROBA-PLUS must be laid as an area drainage layer between the waterproofing layer and the screed. The visual gap created between the waterproofing and the screed, due to the installation of the drainage layer, can be covered by attaching the drip lip. The drip lip cannot prevent the dripping water from coming into contact with the front edge or the wall area in all cases.

Maintenance

Schlüter®-BARA-RK requires no special or preventative maintenance. The aluminium profile's powder-coated surface is colourfast. Damage to the surface shall be repaired by re-coating.

Text template for tenders:

Supply

_____ per metre Schlüter®-BARA-RK as a T-shaped edging profile, made of powder-coated aluminum with a sloped projecting drip edge, and install the trapezoid-perforated anchoring leg into the mortar bed in a professional manner and according to the manufacturer's specifications. Accessory parts, such as inside/outside corners and connectors

■ are to be included in unit prices.

■ are to be charged as extra.

Profile height: _____ mm

Colour: _____

Art.-No.: _____

Material: _____/m

Labour: _____/m

Total: _____/m



Product Overview

Schlüter®-BARA-RK

Colours: HB = light beige, RB = red brown, SB = black brown, PG = pastel grey, BW = brilliant white,

GM = grey metallic

Length supplied: 2.50 m

Colours	HB	RB	SB	PG	BW	GM
Profile	•	•	•	•	•	•
Outside Corner 90°	•	•	•	•	•	•
Outside Corner 135°	•	•	•	•	•	•
Inside Corner 90°	•	•	•	•	•	•
Connector	•	•	•	•	•	•