

Schlüter®-BARA-R

Edging profile
for screed installations

5.2

Product data sheet

Application and Function

Schlüter®-BARA-R is a T-shaped edging profile for the exposed edges of floor assemblies on balconies and terraces. The profile provides a neat edge appearance while protecting the exposed edges of the floor surface against weathering and corrosion. During the application of the screed, the trapezoid-perforated anchoring leg of Schlüter®-BARA-R is solidly embedded in the mortar bed while the upper edge of the profile is used to screed the mortar bed to the appropriate height. Install Schlüter®-TROBA-PLUS as surface drainage between the waterproofing layer and the mortar bed in order to prevent penetrating water from collecting in the screed layer.

If Schlüter®-DITRA 25 is to be installed, the screed is levelled 3 mm below the top of the profile. Schlüter®-DITRA 25 uncouples the tile covering from the screed and neutralises stresses caused by differential movement, primarily due to temperature fluctuations, between the screed and the tile. In addition, Schlüter®-DITRA 25 in conjunction with the tile covering creates a bonded surface-waterproof layer.

Material

Schlüter®-BARA-R is made of chromated colour-coated aluminium.



Material properties and areas of application

The powder coating on the aluminium profile is colourfast as well as UV and weather-resistant. The surface must be protected against abrasion.

Penetrating water must not collect in the screed bed into which Schlüter®-BARA-R has been anchored (installation of drainage layer), since water enriched with alkali will attack aluminium. In special cases, the suitability of Schlüter®-BARA-R must be verified based on the anticipated chemical, mechanical, and/or other stresses.

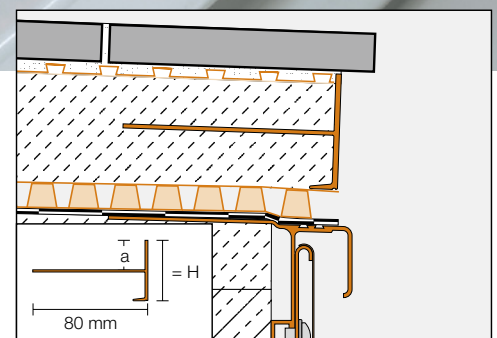



Installation

1. Schlüter®-BARA-R is placed at the edge area and using a mortar layer, it is set to the right height and aligned. For outside corners, corresponding special corner pieces are available. Between the ends of two profiles, a space of approximately 5 mm is left and covered by clipping on a connector.
2. Balcony and terrace surfaces shall be filled with mortar to the height at which the mortar bed's structural reinforcement (AKS lattice) is placed. In doing so, the reinforcing lattice must overlap the anchoring leg of the profile.
3. To produce the load distribution layer, the screed mortar is applied at the appropriate height and slope using the upper edge of Schlüter®-BARA-R as a screeding guide. If Schlüter®-DITRA 25 is to be installed as an uncoupling and bonded waterproof membrane, the screed is levelled 3 mm below the top of the profile and carefully compacted.
4. Please Note:
Schlüter®-TROBA-PLUS must be laid as an area drainage layer between the waterproofing layer and the screed.

5. Tiles shall be laid in such a way that they extend approximately 20 mm beyond the edge of the profile. When using an L-shaped ceramic edge trim, a space of approximately 10 mm must be left between the vertical leg and Schlüter®-BARA-R.

Maintenance

Schlüter®-BARA-R requires no special or preventative maintenance. The aluminium profile's powder-coated surface is colourfast. Damages to the surface shall be repaired by re-coating.

Text template for tenders:

Supply _____ per metre Schlüter®-BARA-R as a T-shaped edging profile, made of powder-coated aluminium, and install the trapezoid-perforated anchoring leg into the load-distribution layer in a professional manner and according to the manufacturer's specifications.
 Accessories, such as corners and connectors
 are to be included in unit prices.
 are to be charged as extra.
 Profile height: _____ mm
 Colour: _____
 Art.-No.: _____
 Material: _____/m
 Labour: _____/m
 Total: _____/m

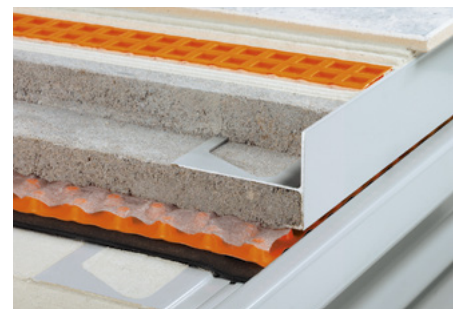

Product Overview

Schlüter®-BARA-R

Colours: RB = red brown, PG = pastel grey

Length supplied: 2.50 m

Colours	RB	PG
H = 50 mm / a = 29 mm	•	•
H = 70 mm / a = 44 mm	•	•
Corner 90°	•	•
Connector	•	•