

# Schlüter®-DILEX-MP/-MPV

**Movement joint profile**  
for screed bed applications

# 4.3

Product data sheet



## Application and Function

**Schlüter®-DILEX-MP** is a profile made of rigid PVC and soft CPE that adjusts to the assembly height of the surface covering by attaching the Schlüter®-DILEX-MPV extension profile. The profile system is suitable for the creation of expansion joints in floor coverings made of ceramic tile, natural stone, brick or synthetic pavers over screed mortar beds. The profile separates the individual covering sections and equalises compression stresses in its centre segment of soft CPE. Expansion stresses that may occur cannot be absorbed, as the profile does not have lateral anchoring in the screed mortar bed.

The lateral edges of the rigid PVC profile, which are covered by a soft CPE movement zone of approximately 1 mm at the top, protect the edges of adjoining covering materials from minor mechanical impact, e.g. in residential settings, offices or sales rooms.

Schlüter®-DILEX-MP may also be inserted in saw cut joints or wider cut joints, e.g. in the case of renovations. The remaining joint between the tile and the profile must be filled completely with grout or epoxy.

## Material

Schlüter®-DILEX-MP consists of recycled rigid PVC side sections that feature dove-tailed anchoring ribs, connected at the top by a soft CPE movement zone. The Schlüter®-DILEX-MPV extension profile is made of recycled rigid PVC.



## Material properties and areas of application

The profile is resistant to most chemicals encountered in tiled environments.

In special cases, the suitability of a proposed type of material must be verified based on the anticipated chemical, mechanical and/or other stresses. The CPE movement zone of the profile is UV resistant and plasticizer free. Schlüter®-DILEX-MP / -MPV creates a movement joint in tiled surfaces set into a mortar bed. Individual covering fields are separated by the profile whose soft CPE movement zone equalises respective compressive stresses.

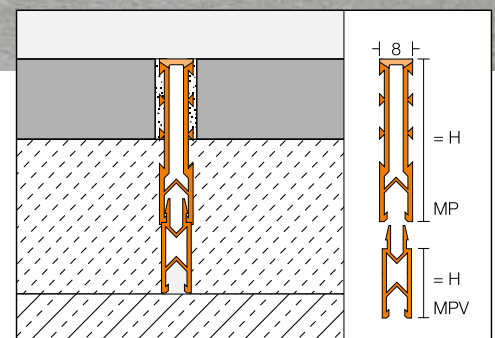



## Installation

1. Adjust profile according to design height by attaching snap-on extensions (Schlüter®-DILEX-MPV).
2. Set profile flush against the edge area of an already completed tile covering. The profile must be solidly embedded laterally.
3. Install surface of adjacent tile covering flush against profile surface. Schlüter®-DILEX-MP must be solidly embedded laterally.
4. Fill the remaining joint between the profile and the covering completely with grout.

### Installation note on joint repair:

Prepare the joint's width and depth appropriately and insert or drive profile into joint. Fill joint space between profile and covering completely with grout, epoxy or dry set mortar.

## Maintenance

Schlüter®-DILEX-MP is resistant to fungi and bacteria and requires no special maintenance. Clean the profile along with the tiled surface using common household cleaning agents.



### Text template for tenders:

#### Supply

\_\_\_\_\_ per metre Schlüter®-DILEX-MP as a movement joint profile, height: 35 mm, for floor coverings set in a screed mortar bed, consisting of recycled rigid PVC side sections that feature dove tailed anchoring ribs, connected at the top by a soft CPE movement zone . . .

. . . additionally with

\_\_\_\_\_ per metre Schlüter®-DILEX-MPV extension profile, height: 15 mm, to fit the height of the assembly

\_\_\_\_\_ per metre Schlüter®-DILEX-MPV extension profile, height: 25 mm, to fit the height of the assembly . . .

. . . and install flush with surface coverings according to manufacturer's specifications.

Colour: \_\_\_\_\_

Art.-No.: \_\_\_\_\_

Material: \_\_\_\_\_/m

Labour: \_\_\_\_\_/m

Total: \_\_\_\_\_/m

## Product Overview

### Schlüter®-DILEX-MP

Colours: G = grey, ZR = brick red, HB = light beige, GS = black

Length supplied: 2.50 m

Colours	G	ZR	HB	GS
H = 35 mm	•	•	•	•

### Schlüter®-DILEX-MPV

Mortar bed profile extension

Length supplied: 2.50 m

Height	MPV
H = 15 mm	•
H = 25 mm	•

## Application areas depending on local traffic load



### Foot traffic

Total weight —



### Shopping carts

Total weight max. 0.4 t



### Cars

Total weight max. 3.5 t



### Trucks

Total weight max. 40 t



### Forklifts

*Pneumatic tyres*

Total weight max. 5 t

*Solid rubber tyres*

Total weight max. 2.5 t



### Pallet trucks

*Hard rubber tyres*

Total weight max. 2.5 t

(Pallet trucks must have tandem axles)

● Suitable

● Unsuitable