

## Schlüter®-QUADEC-FS

Wall Corners And Edge Profiles  
for decorative wall design

# 2.11

Product data sheet

### Application and function

**Schlüter®-QUADEC-FS** is a border profile for creating visually appealing designs in interior wall coverings. These profiles can be combined with the corresponding Schlüter®-QUADEC profiles for outside wall corners. Schlüter®-QUADEC-FS has two visible surfaces, approximately 10 mm wide. The 50 mm open space of the profile can accept tiles to match the wall design or other materials as a contrasting insert. The aluminium profiles, which are available in a wide range of finishing options, allow for decorative design and create interesting visual contrasts.

### Material

Schlüter®-QUADEC-FS is made of aluminium and is available in a variety of anodised surface finishing options.

### Material properties and areas of application

The suitability of Schlüter®-QUADEC-FS must be verified based on the anticipated chemical stresses. Aluminium is sensitive to alkaline media. Cementitious materials, in conjunction with moisture become alkaline. Since aluminium is sensitive to alkaline substances, exposure to the alkali (depending on the concentration and duration of exposure) may result in corrosion (aluminium hydroxide formation).

Therefore, it is important to immediately remove mortar or grout residue from visible surfaces. In addition, ensure that the profile is solidly embedded in the setting material. Schlüter®-QUADEC-FS profiles have an

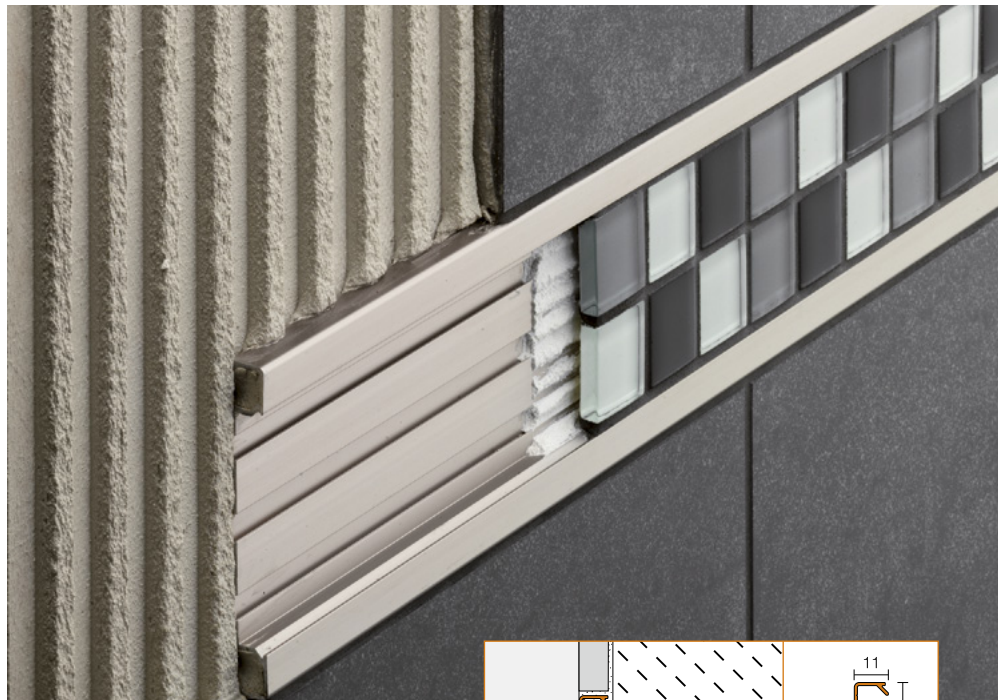

anodised surface layer that retains a uniform appearance during normal use. The surface must be protected against abrasion.

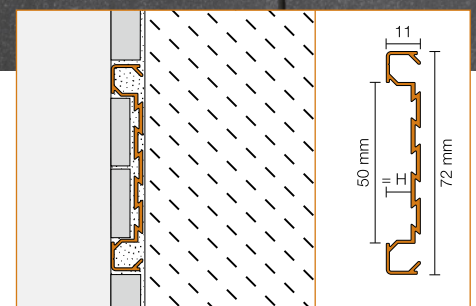



## Installation

1. Schlüter®-QUADEC-FS can be used in flush assemblies with tiles that are thicker than 11 mm. If thinner coverings are used, the profile protrudes over the adjoining covering.
2. Install the tile covering up to the location where Schlüter®-QUADEC-FS is to be installed as a decorative strip. Apply a sufficient amount of tile adhesive to this location or the back of Schlüter®-QUADEC-FS and embed the profile in such a way that the visible surfaces are flush with the adjoining tile covering or protrude evenly over it.
3. Install the next adjoining row of tiles, leaving a space of approx. 2 mm between the tile and the profile for grouting.
4. Use suitable materials and tools for the sensitive surfaces to avoid scratches or other damage. Mortar and tile adhesive should be removed immediately.
5. Matching preformed inside and outside corner pieces are available.

## Notes

The visible surface of Schlüter®-QUADEC-FS requires no special maintenance or care. Do not use abrasive cleaning agents on the sensitive surfaces. Damaged anodised surfaces can be restored with paint.

## Product Overview

### Schlüter®-QUADEC-FS

AE = satin anodised aluminium / AT = titanium anodised aluminium

Supplied length: 2.50 m

Material	AE	AT
Profile	•	•
Corner	•	•

### Text template for tenders:

\_\_\_\_\_ linear metres of Schlüter®-QUADEC-FS as a decorative border profile with two right-angled visible areas with a width of 10 mm and an open space for decorative inserts, to be supplied and professionally installed.

The installation of preformed parts such as inside and outside corners

■ is to be included in the unit prices.

■ is to be charged separately.

The installation instructions of the manufacturer must be observed.

Material:

■ - AE = satin anodised aluminium

■ - AT = titanium anodised aluminium

Item no: \_\_\_\_\_

Material: \_\_\_\_\_ ...../m

Labour: \_\_\_\_\_ ...../m

Total price: \_\_\_\_\_ ...../m

