

Schlüter®-DESIGNBASE-CQ

Wall corners and finishing profiles
Skirting profile with integrated cable duct

16.3

Product data sheet

Application and function

Schlüter®-DESIGNBASE-CQ is a high-quality profile made from colour-coated or anodised aluminium for creating skirting covers with an integrated cable duct. The profile is available in heights of 60 and 80 mm and is attached to the wall with a height-adjustable plastic bracket. The integrated chambers of the support profile are designed to conceal multimedia cables such as HDMI, VGA, telephone or network cables. The corresponding cable outlets are available as accessories. When the profile is flush-mounted on a wall, a shadow joint can be created with an optional aluminium angle. The attractive appearance of Schlüter®-DESIGNLINE-CQ is an excellent fit for the QUADDEC and DESIGNLINE product lines. The profile can be equipped with a sealing lip that is available as an accessory to protect the edge joint from moisture and to reduce the transmission of impact sound. A matching component is available for the simple and decorative design of internal and external corners and as an end cap.

Material

Schlüter®-DESIGNBASE-CQ is available in the following material finishes:
AE = Anodised aluminium
AEEB = Stainless steel effect anodised aluminium
AC = Colour coated aluminium

Material properties and areas of application:

In special cases, the suitability of the profile must be verified based on the anticipated chemical and mechanical stresses. The



information provided below is intended as a general guideline.

Schlüter®-DESIGNBASE-CQ-AE/-AEEB (anodised aluminium): The aluminium features an anodised finish that retains a uniform appearance during normal use. Damaged anodised surfaces can be restored with paint. Visible surfaces should be protected against abrasion. Aluminium is sensitive to alkaline media. Cementitious materials, in conjunction with moisture, become alkaline.

Depending on the concentration and duration of exposure, this may result in corrosion (aluminium hydroxide formation).

For this reason, mortar or grouting material must be removed immediately from all visible areas and freshly installed coverings

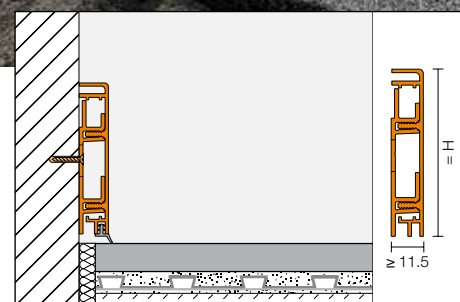



should not be covered with polythene type foil protection.

Schlüter®-DESIGNBASE-CQ-AC (colour-coated aluminium): The aluminium is pre-treated (chrome-plated) and powder-coated with a polyurethane covering. The coating is colour-stable as well as UV- and weather-resistant. Visible edges should be protected against abrasion.

Installation

Schlüter®-DESIGNBASE-CQ is mounted on the wall as follows, using the supplied spacers and screw set.

1. Place the spacers on the floor—in front of the wall - and position the support profile.
2. If using the sealing lip Schlüter®-DESIGNBASE-CQ/Z in the floor area, which is available as an accessory, place the supplied spacers on top of the previously positioned spacers. You can also use the sealing lip as a wall finishing edge in the upper profile area (see Figure for item 6).
3. Transfer the markings of the pre-punched rectangular holes to the wall, and then drill holes with a depth of 40 mm for the enclosed wall anchors, using a drill bit (Ø 6 mm).

Note: As an option, the positioned support profile can also be attached via the guide groove with drywall screws (not included). However, no subsequent correction of the profile height is possible after that.
4. The skirting profile can be supplemented with a shadow joint angle profile (not included in the scope of supply) - see drawing of shadow joint angle profile Schlüter®-DESIGNBASE-CQ/ SG. It is placed in the designated area of the support profile. It can also be installed in the wall area with the installation adhesive Schlüter®-KERDI-FIX.

Immediately remove any excess adhesive from the profile with a suitable detergent.

5. If using the sealing lip Schlüter®-DESIGNBASE-CQ/Z, integrate it into the design profile prior to placing the design profile on the support profile. If the sealing lip is installed in a corner, cut it a little longer in the area of the abutting profiles. Then make an approx. 10 mm cut into the sealing lip with a utility knife on each side and cut the lower part of the sealing lip at an angle of 45°.
6. Now remove the spacers and evenly press the design profile into the support profile.
7. If using corner pieces, insert them laterally into the profile.

Note

Schlüter®-DESIGNBASE-CQ requires no special maintenance or care. Do not use abrasive cleaning agents on the sensitive surfaces. Damaged anodised surfaces can be restored with paint. All cleaning agents must be free of hydrochloric and hydrofluoric acid.

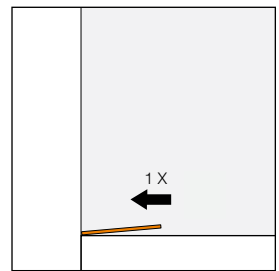

Step. 1.

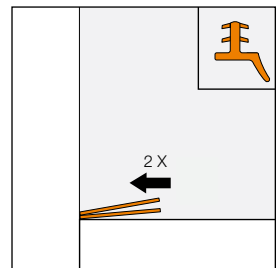

Step. 2.

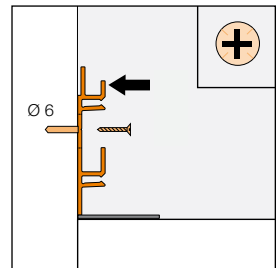

Step. 3.

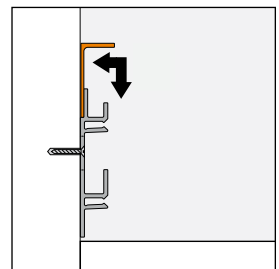

Step. 4.

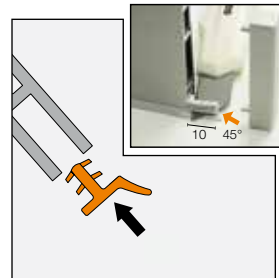

Step. 5.

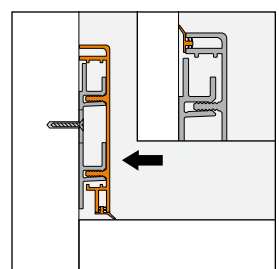

Step. 6.



Product overview:

Schlüter®-DESIGNBASE-CQ-AE

AE = Anodised aluminium /

AEEB = Stainless steel anodised aluminium

Supplied length: 2.50 m

H = mm	60	80
AE	•	•
AEEB	•	•
Corner/end cap	•	•
Sealing lip	•	•

Colours

Sealing lip: MBW = brilliant white satin PG = pastel grey

Schlüter®-DESIGNBASE-CQ-AC

AC = Colour coated aluminium

Supplied length: 2.50 m

H = mm	60	80
MBW	•	•
Corner/end cap	•	•
Sealing lip	•	•

Colours

Profile: MBW = brilliant white satin

Sealing lip: MBW = brilliant white satin PG = pastel grey

Schlüter®-DESIGNBASE-CQ/SG

AE = Anodised aluminium /

AEEB = Stainless steel anodised aluminium /

AC = Colour coated aluminium

Supplied length: 2.50 m

H = mm	12.5
AE	•
AEEB	•
MBW	•

Colours: MBW = brilliant white satin

Schlüter®-DESIGNBASE-CQ/O

AE = Anodised aluminium /

AEEB = Stainless steel anodised aluminium /

AC = Colour coated aluminium

Supplied length: 0.15 m

H = mm	60	80
AE	•	•
AEEB	•	•
MBW	•	•

Colours: MBW = brilliant white satin

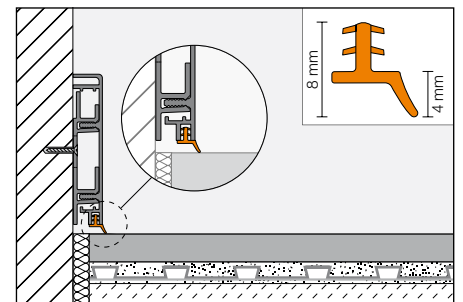

Sealing lip: Schlüter®-DESIGNBASE-CQ/Z

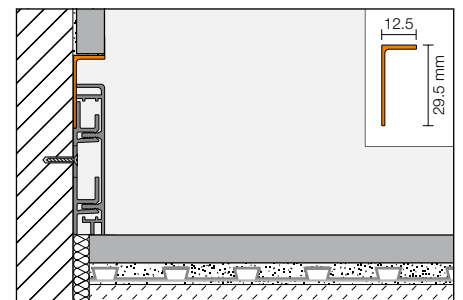

Shadow joint angle profile Schlüter®-DESIGNBASE-CQ/SG



Cable outlet Schlüter®-DESIGNBASE-CQ/O

Text template for tenders:

_____linear metres of Schlüter®-DESIGNBASE-CQ as high-quality profile for creating decorative skirting covers with integrated chambers for concealing multimedia cables, to be supplied and professionally installed. The installation of the prefabricated part as an exterior corner, interior corner, or end cap or of the sealing lip is to be

- included in the unit prices,
- invoiced separately.

The installation instructions of the manufacturer must be observed.

Material:

- AE = Anodised aluminium
- AEEB = Stainless steel effect anodised aluminium
- AC = Colour coated aluminium

Art. No.: _____

Material: _____ /m

Labour: _____ /m

Total: _____ /m

