

## Schlüter®-DILEX-EK / -RF

Corner profile  
for flexible corner connections

# 4.14

Product data sheet

### Application and Function

**Schlüter®-DILEX-EK** and **Schlüter®-DILEX-RF** are two piece profiles with a tongue and groove connection for permanently flexible corner joints at floor/wall transitions and skirting. **Schlüter®-DILEX-EK** and **Schlüter®-DILEX-RF** can absorb especially extensive movements of up to 8 mm. Such movements occur particularly in edge joints of coverings over floating screeds and in heated screeds in the area of floor/wall transitions and along skirting.

The trapezoid perforated, lateral anchoring legs of the profile are firmly embedded in the tile adhesive of the floor covering. The chamber of the lower profile portion of **Schlüter®-DILEX-EK** allows for sliding the cut edges of floor tiles into place. The profile **Schlüter®-DILEX-RF** does not have such a chamber. This allows for a wide selection of tile thicknesses, since tiles can be installed at a lower level. The reduced size of the visible area makes the edge joint appear narrow and decorative. The flexible tongue and groove connection is capable of absorbing movements up to 8 mm. The use of **Schlüter®-DILEX-EK** and **Schlüter®-DILEX-RF** reliably prevents the formation of sound bridges in the floor/wall transition, which reduces the transmission of sound.



### Material

**Schlüter®-DILEX-EK** and **Schlüter®-DILEX-RF** consist of a material combination of recycled rigid PVC for the lateral anchoring legs and soft CPE for the expansion zone of the tongue and groove connection. The visible areas are of identical colour.

### Material properties and areas of application

**Schlüter®-DILEX-EK** and **Schlüter®-DILEX-RF** are used as corner movement profiles for floor/wall transitions of tile coverings installed in the thin-bed method. The material is resistant to the chemical stresses that are typically associated with tile coverings.

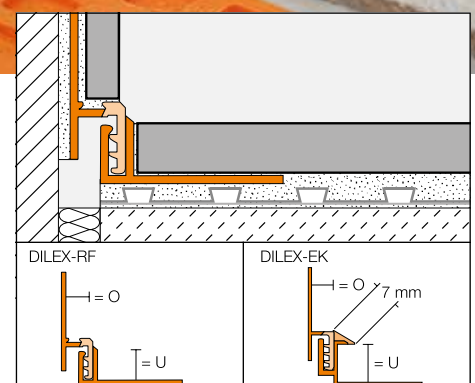



The CPE material is UV- and weather-resistant as well as specially treated to resist fungal and bacterial growth and suited for contact with food. CPE stands out for its resistance to a variety of acids, alkalis, oils, fats and solvents. In special cases, the suitability of the selected profile type must be verified based on the anticipated chemical, mechanical, and/or other stresses.

#### Installation of Schlüter®-DILEX-EK

1. Select Schlüter®-DILEX-EK according to the tile thickness, where O= thickness of wall or skirting tiles, and U= thickness of the floor tiles. The height "U" of the profile must be sufficient to easily insert the floor tile into the chamber (e.g., U 11 for a tile thickness of approx. 8-10 mm).
2. Apply tile adhesive to the attachment points of the trapezoid-perforated anchoring legs. Firmly press the profile into place and trowel adhesive over the anchoring legs. As an alternative, Schlüter®-DILEX-EK may also be loosely installed, with adhesive trowelled over the anchoring legs during tile installation.
3. Insert the floor tiles into the profile chamber, and install the wall or skirting tiles above the profile, leaving a joint of approx. 2 mm. Avoid the formation of hollow cavities in the area of the anchoring leg.
4. Completely fill the space between the tile and the profile with grout.

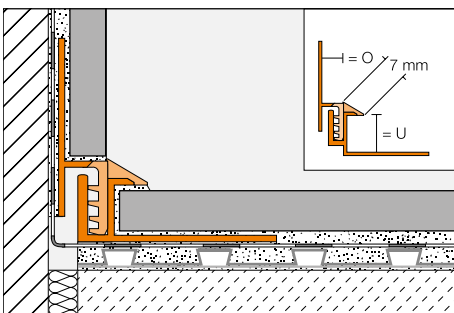

Schlüter®-DILEX-EK



#### Installation of Schlüter®-DILEX-RF

1. Select Schlüter®-DILEX-RF according to the tile thickness, where O= thickness of wall or skirting tiles, and U= thickness of the floor tiles. The height "U" of the profile must be sufficient to ensure that the floor tile does not protrude over the coloured visible surface of the profile (e.g., U 10 for a tile thickness of approx. 6-9 mm).
2. Apply tile adhesive to the attachment points of the trapezoid-perforated anchoring legs. Firmly press the profile into place and trowel adhesive over the anchoring legs. As an alternative, Schlüter®-DILEX-RF may also be loosely installed, with adhesive trowelled over the anchoring legs during tile installation.
3. Install the floor, wall or skirting tiles above the profile, leaving a joint of approx. 2 mm. Avoid the formation of hollow cavities in the area of the anchoring leg.
4. Completely fill the space between the tile and the profile with grout.

#### Maintenance

Schlüter®-DILEX-EK and -RF are specially treated to resist fungal and bacterial growth and require no special maintenance or care. They can be cleaned with regular household detergents when cleaning the tile covering.



## Product Overview

### Schlüter®-DILEX-EK

Colours: G = grey, PG = pastel grey, BW = brilliant white, HB = light beige, GS = black

Length supplied: 2.50 m

Colours	G	PG	BW	HB	GS
U = 8 mm / O = 7 mm	•	•	•	•	•
U = 11 mm / O = 7 mm	•	•	•	•	•
U = 15 mm / O = 7 mm	•				
U = 8 mm / O = 10 mm	•	•	•	•	•
U = 11 mm / O = 10 mm	•	•	•	•	•
U = 15 mm / O = 10 mm	•				
U = 8 mm / O = 14 mm	•				
U = 11 mm / O = 14 mm	•				
U = 15 mm / O = 14 mm	•				

### Schlüter®-DILEX-RF

Colours: G = grey, PG = pastel grey

Length supplied: 2.50 m

Colours	G	PG
U = 10 mm / O = 8 mm	•	•
U = 12.5 mm / O = 8 mm	•	•
U = 15 mm / O = 8 mm	•	•
U = 18 mm / O = 8 mm	•	•
U = 22 mm / O = 8 mm	•	•
U = 10 mm / O = 10 mm	•	•
U = 12.5 mm / O = 10 mm	•	•
U = 15 mm / O = 10 mm	•	•
U = 18 mm / O = 10 mm	•	•
U = 22 mm / O = 10 mm	•	•
U = 10 mm / O = 12.5 mm	•	•
U = 12.5 mm / O = 12.5 mm	•	•
U = 15 mm / O = 12.5 mm	•	•
U = 18 mm / O = 12.5 mm	•	•
U = 22 mm / O = 12.5 mm	•	•
U = 10 mm / O = 15 mm	•	•
U = 12.5 mm / O = 15 mm	•	•
U = 15 mm / O = 15 mm	•	•
U = 18 mm / O = 15 mm	•	•
U = 22 mm / O = 15 mm	•	•
U = 10 mm / O = 18 mm	•	•
U = 12.5 mm / O = 18 mm	•	•
U = 15 mm / O = 18 mm	•	•
U = 18 mm / O = 18 mm	•	•
U = 22 mm / O = 18 mm	•	•

**Text template for tenders:**

Supply

\_\_\_\_\_ per metre Schlüter®-DILEX-EK as two part corner profile with a tongue and groove connection for permanent flexible corner joints between floor and skirting or wall tiles, featuring trapezoid perforated anchoring legs made of rigid PVC and a movement zone made of soft CPE and a chamber to insert floor tiles, suitable for accepting vertical movements up to approx. 8 mm, and install according to the manufacturer's specifications.

Profile height U: \_\_\_\_\_

Profile height O: \_\_\_\_\_

Colour: \_\_\_\_\_

Art.-No.: \_\_\_\_\_

Material: \_\_\_\_\_/m

Labour: \_\_\_\_\_/m

Total: \_\_\_\_\_/m

**Text template for tenders:**

Supply

\_\_\_\_\_ per metre Schlüter®-DILEX-RF as two part corner profile with a tongue and groove connection for permanent flexible corner joints between floor and skirting or wall tiles, featuring trapezoid perforated anchoring legs made of rigid PVC and a movement zone made of soft CPE, suitable for accepting vertical movements up to approx. 8 mm, and install according to the manufacturer's specifications.

Profile height U: \_\_\_\_\_

Profile height O: \_\_\_\_\_

Colour: \_\_\_\_\_

Art.-No.: \_\_\_\_\_

Material: \_\_\_\_\_/m

Labour: \_\_\_\_\_/m

Total: \_\_\_\_\_/m